

# N-CPST longitudinal conveyor under the press with paddle separator

## TECHNICAL DATA SHEET

### DRIVE UNIT

- Position: pendular on the RH side
- Gear motor power: 0.12 kW
- Conveyor speed: 3 m/min fixed
- Control: Siemens Start and Stop switch/motor cut-out
- Connection Voltage: 400 Volts/50 Hz
- Connection plug: 4P (3 phases+ground)

### BELT

- Embossed green PVC covering (ref. Pantone 320)
- Vulcanised belt joint
- Temperature resistance: -10°C to +60°C

### SECTION

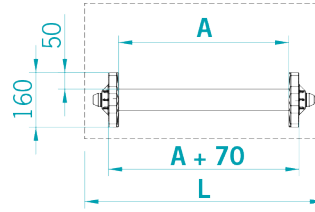

A (mm)	<input type="checkbox"/> 140	<input type="checkbox"/> 240
	<input type="checkbox"/> 340	<input type="checkbox"/> 440
D (mm)		
E (mm)		
F (mm)		
G (mm)		
H (mm)		
I (mm)		
L (mm)		
Capacity (Kg)		
Material to be conveyed		
Specify presence of lubricant, coolant or other fluid, if present.		

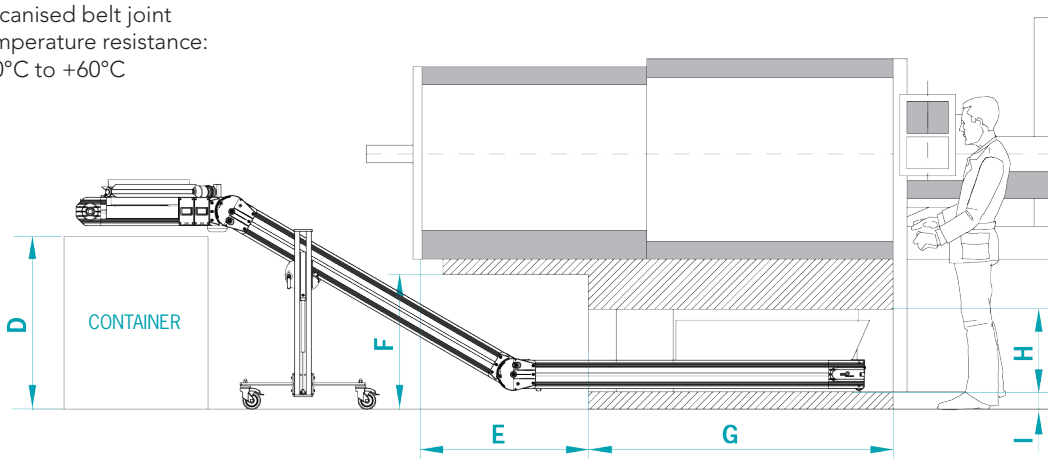

## OPTIONAL

### DRIVE UNIT

- Mounted on opposite side: RH side

### MB TOP CONTROL 400 Volt/3/50 Hz

- Mod. NEW TOP CONTROL complete with programs and with three-phase Inverter

### STANDARD FUNCTIONS

- Adjustable speed from \_\_\_\_\_ to \_\_\_\_\_ mt/min.
- Pause/Work for step-by-step advancement
- Robot/Pulse for timed advancement by external command

### UNLOADING CHUTE

- Standard unloading chute

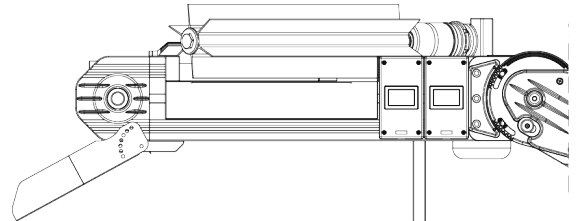

### NOTES